



Section 1 of 21

You can save the form at any time and resume it later. You do not need to be logged in when you resume.

System reference This is the unique reference for this application generated by the system.

Your reference You can put what you want here to help you track applications if you make lots of them. It is passed to the authority.

Are you an agent acting on behalf of the applicant? Put "no" if you are applying on your own behalf or on behalf of a business you own or work for.

Yes No

Applicant Details

* First name

* Family name

* E-mail

Main telephone number Include country code.

Other telephone number

Indicate here if you work for the applicant

Are you:

Applying as a business owner

Applying as an individual

A sole trader is a business owned by one person without any special legal structure. Applying as an individual means you are applying so you can be employed, or for some other personal reason, such as following a hobby.

Continued from previous page...

Your Address

Address official correspondence should be sent to.

* Building number or name

* Street

District

* City or town

County or administrative area

* Postcode

* Country

Section 2 of 21

PREMISES DETAILS

I/we, as named in section 1, apply for a premises licence under section 17 of the Licensing Act 2003 for the premises described in section 2 below (the premises) and I/we are making this application to you as the relevant licensing authority in accordance with section 12 of the Licensing Act 2003.

Premises Address

Are you able to provide a postal address, OS map reference or description of the premises?

Address OS map reference Description

Postal Address Of Premises

Building number or name	THE CABIN
Street	LUCIUS STREET
District	
City or town	TORQUAY
County or administrative area	DEVON
Postcode	TQ2 5UW
Country	United Kingdom

Further Details

Telephone number	01803 400293
Non-domestic rateable value of premises (£)	4,200

Section 3 of 21

APPLICATION DETAILS

In what capacity are you applying for the premises licence?

- An individual or individuals
- A limited company / limited liability partnership
- A partnership (other than limited liability)
- An unincorporated association
- Other (for example a statutory corporation)
- A recognised club
- A charity
- The proprietor of an educational establishment
- A health service body
- A person who is registered under part 2 of the Care Standards Act 2000 (c14) in respect of an independent hospital in Wales
- A person who is registered under Chapter 2 of Part 1 of the Health and Social Care Act 2008 in respect of the carrying on of a regulated activity (within the meaning of that Part) in an independent hospital in England
- The chief officer of police of a police force in England and Wales

Confirm The Following

- I am carrying on or proposing to carry on a business which involves the use of the premises for licensable activities
- I am making the application pursuant to a statutory function
- I am making the application pursuant to a function discharged by virtue of Her Majesty's prerogative

Section 4 of 21

INDIVIDUAL APPLICANT DETAILS

Applicant Name

Is the name the same as (or similar to) the details given in section one?

- Yes No

If "Yes" is selected you can re-use the details from section one, or amend them as required. Select "No" to enter a completely new set of details.

First name

Family name

Is the applicant 18 years of age or older?

- Yes No

Continued from previous page...

Current Residential Address

Is the address the same as (or similar to) the address given in section one?

Yes No

If "Yes" is selected you can re-use the details from section one, or amend them as required. Select "No" to enter a completely new set of details.

Building number or name [

Street |

District

City or town

County or administrative area

Postcode

Country

Applicant Contact Details

Are the contact details the same as the previous applicant's?

Yes No

If "Yes" is selected you can re-use the details from section one, or amend them as required. Select "No" to enter a completely new set of details.

E-mail]

Telephone number]

Other telephone number]

* Date of birth

* Nationality _____

Documents that demonstrate entitlement to work in the UK

Add another applicant

Section 5 of 21

OPERATING SCHEDULE

When do you want the premises licence to start? [] / [] / []
dd mm yyyy

If you wish the licence to be valid only for a limited period, when do you want it to end [] / [] / []
dd mm yyyy

Provide a general description of the premises

For example the type of premises, its general situation and layout and any other information which could be relevant to the licensing objectives. Where your application includes off-supplies of alcohol and you intend to provide a place for consumption of these off-supplies you must include a description of where the place will be and its proximity to the premises.

THE CABIN IS A CONVEINENCE/NEWSAGENTS, I INTEND TO SELL ALCOHOL TO IMPROVE MY BUSINESS AND BE INLINE WITH

Continued from previous page...

OTHER SHOPS IN THE AREA, I INTEND TO RUN THE BUSINESS WITH NO ADVERSE EFFECTS ON THE LOCAL COMMUNITY, all spirits will be displayed behind the counter and sold only by way of counter service, also no super strength beers lagers or ciders of 6.1% abv or above shall be sold on the premises. No single cans will be sold on the premises, CCTV in operation, Challenge 25 policy will be in place, Photo id only, staff training records will be kept, and a refusal and incident log will be kept.

If 5,000 or more people are expected to attend the premises at any one time, state the number expected to attend

Section 6 of 21

PROVISION OF PLAYS

See guidance on regulated entertainment

Will you be providing plays?

- Yes No

Section 7 of 21

PROVISION OF FILMS

See guidance on regulated entertainment

Will you be providing films?

- Yes No

Section 8 of 21

PROVISION OF INDOOR SPORTING EVENTS

See guidance on regulated entertainment

Will you be providing indoor sporting events?

- Yes No

Section 9 of 21

PROVISION OF BOXING OR WRESTLING ENTERTAINMENTS

See guidance on regulated entertainment

Will you be providing boxing or wrestling entertainments?

- Yes No

Section 10 of 21

PROVISION OF LIVE MUSIC

See guidance on regulated entertainment

Will you be providing live music?

- Yes No

Section 11 of 21

PROVISION OF RECORDED MUSIC

See guidance on regulated entertainment

Will you be providing recorded music?

- Yes No

Continued from previous page...

Section 12 of 21

PROVISION OF PERFORMANCES OF DANCE

See guidance on regulated entertainment

Will you be providing performances of dance?

Yes No

Section 13 of 21

PROVISION OF ANYTHING OF A SIMILAR DESCRIPTION TO LIVE MUSIC, RECORDED MUSIC OR PERFORMANCES OF DANCE

See guidance on regulated entertainment

Will you be providing anything similar to live music, recorded music or performances of dance?

Yes No

Section 14 of 21

LATE NIGHT REFRESHMENT

Will you be providing late night refreshment?

Yes No

Section 15 of 21

SUPPLY OF ALCOHOL

Will you be selling or supplying alcohol?

Yes No

Standard Days And Timings

MONDAY

Start

End

Start

End

Give timings in 24 hour clock. (e.g., 16:00) and only give details for the days of the week when you intend the premises to be used for the activity.

TUESDAY

Start

End

Start

End

WEDNESDAY

Start

End

Start

End

THURSDAY

Start

End

Start

End

FRIDAY

Start

End

Start

End

Continued from previous page...

SATURDAY

Start 07:00

End 22:00

Start

End

SUNDAY

Start 07:00

End 22:00

Start

End

Will the sale of alcohol be for consumption:

- On the premises Off the premises Both

If the sale of alcohol is for consumption on the premises select on, if the sale of alcohol is for consumption away from the premises select off. If the sale of alcohol is for consumption on the premises and away from the premises select both.

State any seasonal variations

For example (but not exclusively) where the activity will occur on additional days during the summer months.

Non-standard timings. Where the premises will be used for the supply of alcohol at different times from those listed in the column on the left, list below

For example (but not exclusively), where you wish the activity to go on longer on a particular day e.g. Christmas Eve.

State the name and details of the individual whom you wish to specify on the licence as premises supervisor

Name

First name

LINDSAY

Family name

YOUNG

Date of birth

Continued from previous page...

Enter the contact's address

Building number or name

Street

District

City or town

County or administrative area

Postcode

Country

Personal Licence number
(if known)

Issuing licensing authority
(if known)

TORBAY COUNCIL

PROPOSED DESIGNATED PREMISES SUPERVISOR CONSENT

How will the consent form of the proposed designated premises supervisor be supplied to the authority?

- Electronically, by the proposed designated premises supervisor
- As an attachment to this application

Reference number for consent form (if known)

If the consent form is already submitted, ask the proposed designated premises supervisor for its 'system reference' or 'your reference'.

Section 16 of 21

ADULT ENTERTAINMENT

Highlight any adult entertainment or services, activities, or other entertainment or matters ancillary to the use of the premises that may give rise to concern in respect of children

Give information about anything intended to occur at the premises or ancillary to the use of the premises which may give rise to concern in respect of children, regardless of whether you intend children to have access to the premises, for example (but not exclusively) nudity or semi-nudity, films for restricted age groups etc gambling machines etc.

Section 17 of 21

HOURS PREMISES ARE OPEN TO THE PUBLIC

Standard Days And Timings

MONDAY

Start

End

Start

End

Give timings in 24 hour clock. (e.g., 16:00) and only give details for the days of the week when you intend the premises to be used for the activity.

Continued from previous page...

TUESDAY

Start	<input type="text" value="07:00"/>	End	<input type="text" value="22:00"/>
Start	<input type="text"/>	End	<input type="text"/>

WEDNESDAY

Start	<input type="text" value="07:00"/>	End	<input type="text" value="22:00"/>
Start	<input type="text"/>	End	<input type="text"/>

THURSDAY

Start	<input type="text" value="07:00"/>	End	<input type="text" value="22:00"/>
Start	<input type="text"/>	End	<input type="text"/>

FRIDAY

Start	<input type="text" value="07:00"/>	End	<input type="text" value="22:00"/>
Start	<input type="text"/>	End	<input type="text"/>

SATURDAY

Start	<input type="text" value="07:00"/>	End	<input type="text" value="22:00"/>
Start	<input type="text"/>	End	<input type="text"/>

SUNDAY

Start	<input type="text" value="07:00"/>	End	<input type="text" value="22:00"/>
Start	<input type="text"/>	End	<input type="text"/>

State any seasonal variations

For example (but not exclusively) where the activity will occur on additional days during the summer months.

Non standard timings. Where you intend to use the premises to be open to the members and guests at different times from those listed in the column on the left, list below

For example (but not exclusively), where you wish the activity to go on longer on a particular day e.g. Christmas Eve.

Section 18 of 21

LICENSING OBJECTIVES

Describe the steps you intend to take to promote the four licensing objectives:

a) General – all four licensing objectives (b,c,d,e)

Continued from previous page...

List here steps you will take to promote all four licensing objectives together.

CCTV in operation and regularly maintained covering both inside and outside of the premises. The CCTV will also cover the areas that will contain the stocks of alcohol. The CCTV system retains all data onto hard drive for 28 days and can be copied on request and appropriate authority to do so. Recognising, challenging and ensuring the conduct of persons purchasing products. Close liaison with law enforcement agencies to ensure legality, public safety and protection of children and young persons.. Trained staff with full understanding of the U25 policy that will be in force

b) The prevention of crime and disorder

Using local knowledge identifying offenders involved in crime and disorder and therefore restricting sales to these individuals, liaising and providing evidence when required with the local law enforcement and exchanging information. Ensuring the good conduct of customers entering and leaving this premises.

c) Public safety

Inappropriate and/or poor behaviour will not be tolerated, any person(s) acting unruly or inappropriately will be asked to leave the premises, details of such incidents will be recorded in a log and made available to any authorised officer of the Council or the Police for inspection upon reasonable request.

d) The prevention of public nuisance

A responsible person shall ensure that the area is maintained in a clean and smart manner by regular inspection and cleaning of the area in the immediate vicinity of the premises where appropriate
Discouraging congregating of persons close to the premises, Challenging poor conduct and behaviour

e) The protection of children from harm

The premises licence holder will ensure that an age verification policy will apply to the premises whereby all cashiers will be trained to ask any customer attempting to purchase alcohol, who appears to be under the age of 25 years (or older if the licence holder so elects) to produce, before being sold alcohol, identification being a passport or photo card driving licence bearing a holographic mark or other form of identification bearing the customer's photograph, date of birth and the Proof of Age Standards Scheme (or similarly accredited scheme) hologram.

- All spirits shall be located behind the counter and shall be sold by counter service only.
- Alcohol displays within the premises shall be located so that staff can view these displays at all times.
- There shall be no alcohol displays within 2 metres of the store entrance
- There will be no sales or supply of beers, ales, lager, bitter or cider with an ABV of more than 6%.
- No single cans of alcohol shall be sold from the premises.
- The Premises Licence Holder or Designated Premises Supervisor shall ensure that a Refusals Register is maintained to include details of all alcohol sales that are refused and the reason for refusal. The register shall be retained for a period of 12 months and will be made available to the Police Licensing Officer, and other authorised enforcement officers or Responsible Authorities on request.
- Challenge 25 Posters shall be displayed in prominent positions within the premises and adjacent to the service hatch.
- An Incident Book shall be maintained to record details of the dates, times and details of any incidents occurring on the premises. This Incident Book shall be retained for a period of 12 months and will be made available for inspection at any reasonable time by the Police Licensing Officer, and other authorised enforcement officers or Responsible Authorities on request.
- The Premises Licence Holder or Designated Premises Supervisor shall ensure that all members of staff employed in the sale of alcohol shall receive appropriate training, and regular refreshment training, with regards to the Challenge 25 Policy, the identification of persons who are drunk and refusing service. A record of such training will be maintained and kept on the premises for a period of 12 months and shall be available for inspection at any reasonable time by the Police Licensing Officer, and other authorised enforcement officers or Responsible Authorities on request.
- No persons other than management, their staff, site service providers and members of emergency services shall be allowed access to the premises other than the forecourt between 00:00 and 06:00 daily.

Continued from previous page...

The premises CCTV system will incorporate a camera covering the premises frontage and the serving hatch at the front of the premises.

Section 19 of 21

NOTES ON DEMONSTRATING ENTITLEMENT TO WORK IN THE UK

Entitlement to work/immigration status for individual applicants and applications from partnerships which are not limited liability partnerships:

A licence may not be held by an individual or an individual in a partnership who is resident in the UK who:

- does not have the right to live and work in the UK; or
- is subject to a condition preventing him or her from doing work relating to the carrying on of a licensable activity.

Any premises licence issued in respect of an application made on or after 6 April 2017 will become invalid if the holder ceases to be entitled to work in the UK.

Applicants must demonstrate that they have an entitlement to work in the UK and are not subject to a condition preventing them from doing work relating to the carrying on of a licensable activity. They do this by providing with this application copies or scanned copies of the following documents (which do not need to be certified).

Documents which demonstrate entitlement to work in the UK

- An expired or current passport showing the holder, or a person named in the passport as the child of the holder, is a British citizen or a citizen of the UK and Colonies having the right of abode in the UK [please see note below about which sections of the passport to copy].
- An expired or current passport or national identity card showing the holder, or a person named in the passport as the child of the holder, is a national of a European Economic Area country or Switzerland.
- A Registration Certificate or document certifying permanent residence issued by the Home Office to a national of a European Economic Area country or Switzerland.
- A Permanent Residence Card issued by the Home Office to the family member of a national of a European Economic Area country or Switzerland.
- A **current** Biometric Immigration Document (Biometric Residence Permit) issued by the Home Office to the holder indicating that the person named is allowed to stay indefinitely in the UK, or has no time limit on their stay in the UK.
- A **current** passport endorsed to show that the holder is exempt from immigration control, is allowed to stay indefinitely in the UK, has the right of abode in the UK, or has no time limit on their stay in the UK.
- A **current** Immigration Status Document issued by the Home Office to the holder with an endorsement indicating that the named person is allowed to stay indefinitely in the UK or has no time limit on their stay in the UK, **when produced in combination with** an official document giving the person's permanent National Insurance number and their name issued by a Government agency or a previous employer.
- A **full birth** or adoption certificate issued in the UK which includes the name(s) of at least one of the holder's parents or adoptive parents, **when produced in combination with** an official document giving the person's permanent National Insurance number and their name issued by a Government agency or a previous employer.
- A birth or adoption certificate issued in the Channel Islands, the Isle of Man or Ireland **when produced in combination with** an official document giving the person's permanent National Insurance number and their name issued by a Government agency or a previous employer.
- A certificate of registration or naturalisation as a British citizen, **when produced in combination with** an official document giving the person's permanent National Insurance number and their name issued by a Government agency or a previous employer.
- A **current** passport endorsed to show that the holder is allowed to stay in the UK and is currently allowed to work and is not subject to a condition preventing the holder from doing work relating to the carrying on of a licensable activity.

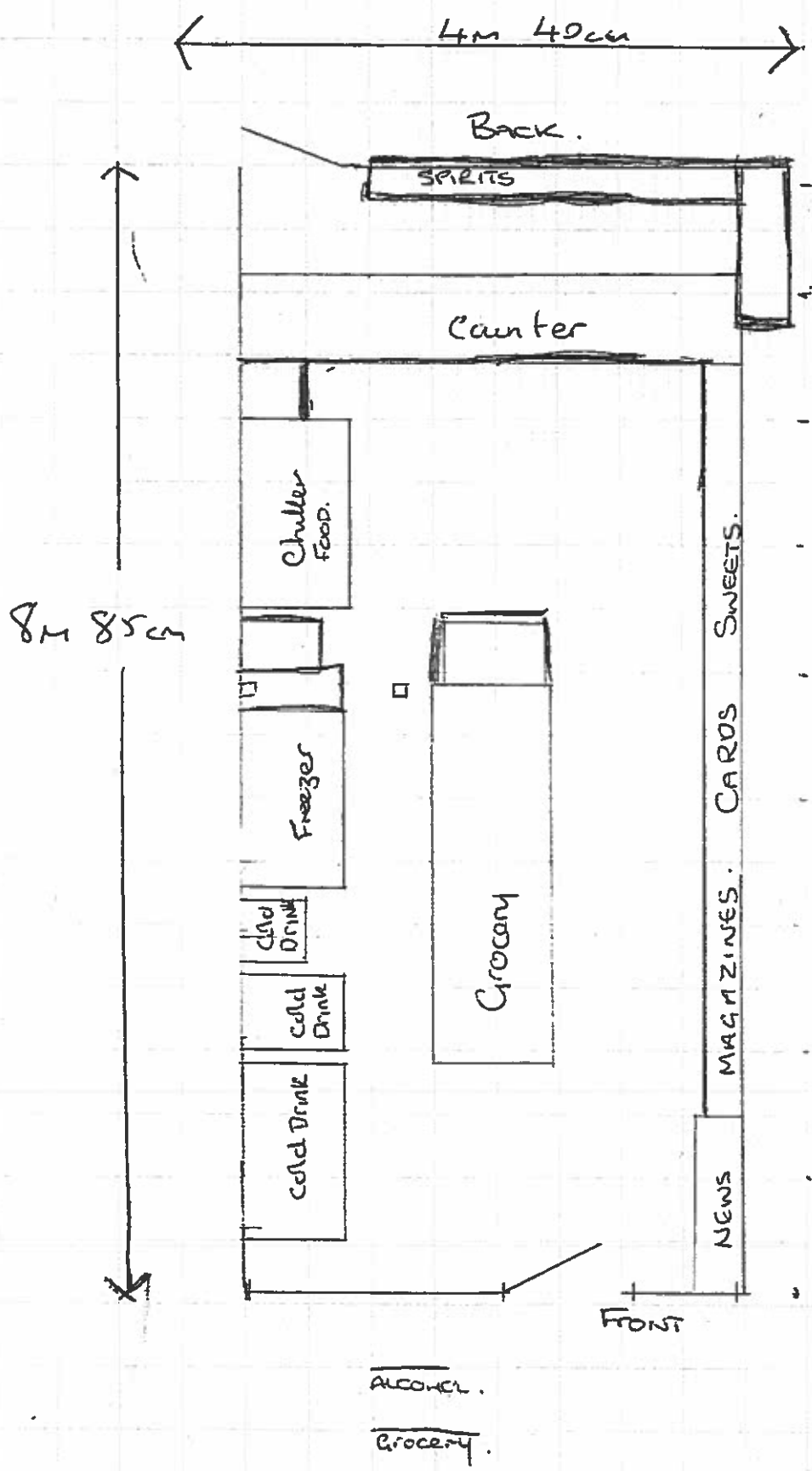

Scale 2cm = 1 metre.